



Blocky for Veeam®

Highest protection against
ransomware through WORM
technology



GRAU DATA

Your data \ Your control _

What is Blocky?

**„Your Last Line of Defense“
against ransomware**

Blocky protects your Windows-based
Veeam backup data against ransomware

Add Blocky to Veeam to create a
“Zero Trust” environment



Why do you need Blocky?

Modern ransomware trojans are systematically searching to infect any high-value data, f.e. backup data.

Traditional data protection procedures such as virus scanners are ineffective against ransomware.



What does Blocky do?

Blocky creates a „**fingerprint**“ for each process accessing Veeam backup files.

Blocky prevents delete or write access if the „fingerprint“ is not explicitly matched for each process.



Unique process

- Only approved whitelisted applications (Veeam) have access to Veeam backup data and are allowed to write, append or delete files.
- Unauthorized access is stopped by the Blocky filter driver, preventing the destruction or encryption of backup data
- Blocky prevents damage to backup data even if a virus has entered the Windows-backup system.

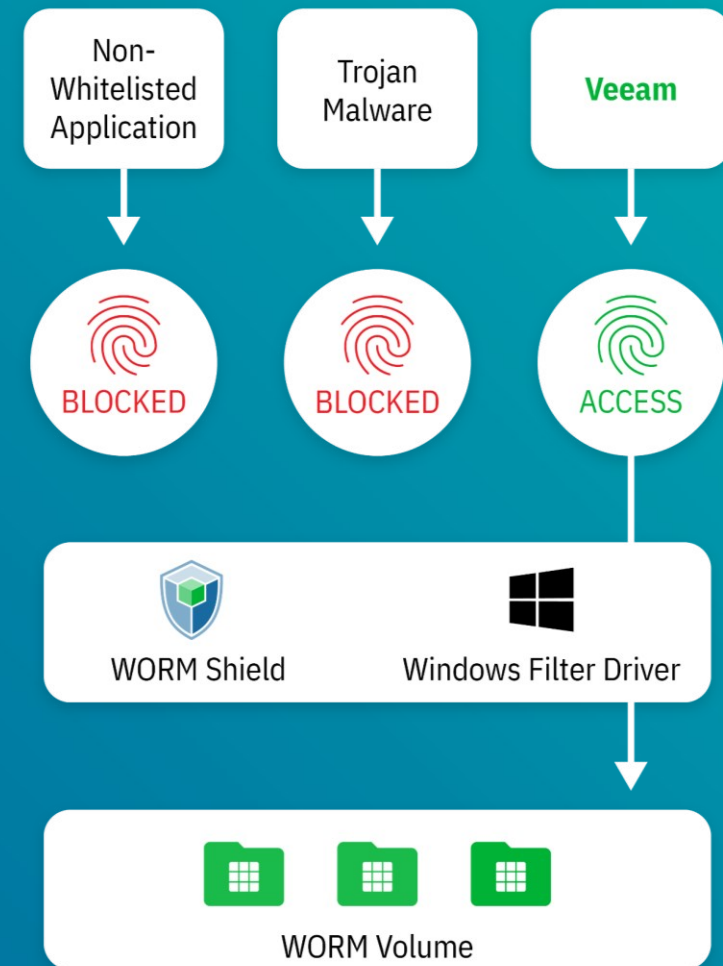

Blocky for Veeam **in action**

Veeam Backup Without Blocky

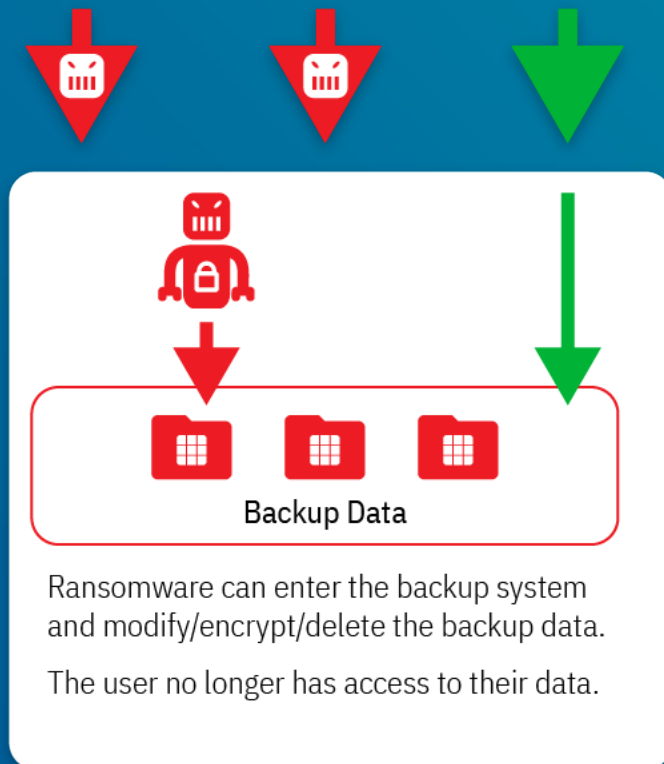

Veeam Backup With Blocky

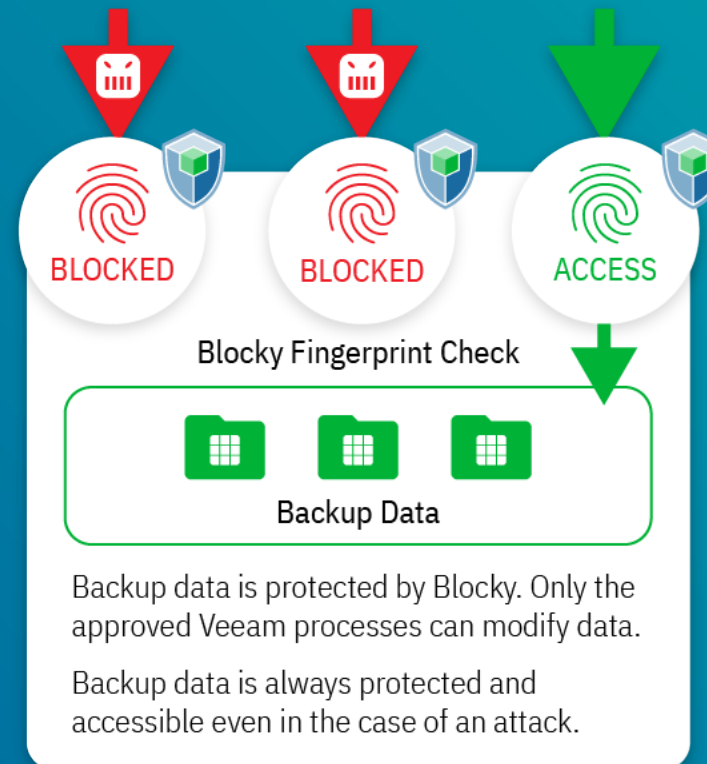

Key Functions

- **Windows file systems used for backup data are transformed into a WORM file system.**
 - Blocky automatically sets the volume as WORM.
 - All accesses into the file system are then controlled via a Window's filter driver.
 - Only processes that have Whitelist permission can create and modify files within the WORM volume and unauthorized processes are blocked.
- **Processes which need permission to modify data (e.g. backup processes):**
 - must be authorized by the administrator
 - have a Blocky fingerprint.
 - fingerprint verification includes the applications DLL's

Key Functions

- **Blocky is designed to prevent hacks and work-arounds:**
 - Blocky requires a **separate password**, independent of SSO and AD, that ensures protection against unauthorized changes and manipulation of the software.
 - Blocky installations are uniquely linked to the server by incorporating the server ID which becomes part of the fingerprint, preventing unauthorized copies, clones or high jacking of the whitelist.
- **Low overhead & high performance**
 - Zero overhead while writing and reading
 - Approx. 2-3 % overhead during delete & append processes.

Scalability

- Starting with SMB customers (50 TB) up to Enterprise customers with multiple PB
- Blocky centralized management only needs to be installed on a single server to support a multi-server environment.



Summary

- Blocky is for Windows-based Veeam repositories on block storage
- No additional hardware or Linux repository required
- Easy installation in minutes
- Lean product design for maximum protection against ransomware
- Reseller requirements: Veeam and Windows knowledge
- GRAU DATA provides hands-on technical training for Reseller
- Attractive pricing for end-user and Veeam® partners



David Cerf

Chief Data Evangelist

david@graudata.us

Phone: +1.972.896.3164

Kai Hambrecht

Head of Service & Support

kai.hambrecht@graudata.com

Phone: +49 7171 187-317



GRAU DATA

Your data \ Your control _